

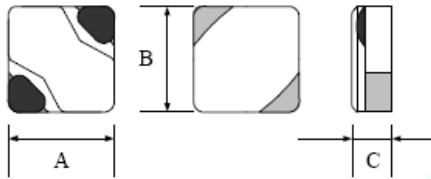

## SMD POWER INDUCTORS – SSDF

### SHAPES & DIMENSION FOR SSDF SERIES (mm)



### RECOMMENDED PATTERN (mm)

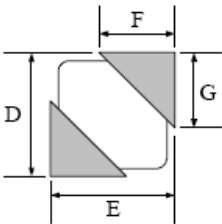

PART NO.	A	B	C	D, E	F, G
SSDF2010	2.2	2.2	1.0	2.3	1.4
SSDF2015	2.2	2.2	1.4	2.3	1.4
SSDF2015C	2.2	2.2	1.4	2.3	1.4
SSDR3010	3.0	3.0	1.1	3.1	1.7
SSDR3015	3.0	3.0	1.4	3.1	1.7
SSDF3015C	3.0	3.0	1.5	3.1	1.7

### ELECTRICAL SPECIFICATION

L(μH)	RDC (OHM) ±20 %						IDC (A) Max.					
	2010	2015	2015C	3010	3015	3015C	2010	2015	2015C	3010	3015	3015C
1.5	0.22	0.11	0.15	0.097	0.041	0.069	0.62	0.75	0.90	1.20	1.00	1.65
1.8					0.050						0.98	
2.2	0.25	0.13	0.20	0.110	0.053	0.098	0.52	0.55	0.75	1.00	0.90	1.40
3.3	0.40	0.20	0.28	0.200	0.087	0.140	0.45	0.48	0.60	0.87	0.85	1.10
4.7	0.45	0.23	0.33	0.280	0.116	0.190	0.35	0.40	0.50	0.70	0.70	0.90
6.8	0.70	0.35	0.50	0.340	0.145	0.270	0.30	0.30	0.40	0.61	0.58	0.85
10	0.88	0.52	0.85	0.580	0.227	0.410	0.22	0.25	0.30	0.45	0.45	0.68
15		0.85	1.05	0.860	0.372	0.500		0.18	0.25	0.40	0.36	0.58
22		1.05		1.130	0.456	0.740		0.15		0.33	0.30	0.48
33					0.825	1.250					0.24	0.35
47					0.963	1.980					0.19	0.30
68					1.583						0.16	

Operating Temperature: -30C ~ +85 C  
Inductance drop ≤ 35% typ. At IDC

Test Freq.: 100KHz/0.5V

## SMD POWER INDUCTORS – SSDE

### SHAPES & DIMENSION FOR SSDE SERIES (mm)

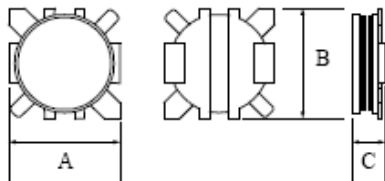

### RECOMMENDED PATTERN (mm)

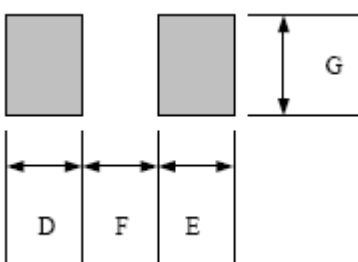

PART NO.	A	B	C	D, E	F	G
SSDE 2610	2.80±0.2	2.60±0.2	1.00 max.	1.20	1.00	1.00
SSDE2810H	3.00±0.2	3.00±0.2	1.00 max.	1.20	1.00	1.00
SSDE3014	3.20±0.3	3.20±0.3	1.40 max.	1.20	1.40	1.40
SSDE3512	3.70±0.3	3.70±0.3	1.20 max.	1.45	1.00	1.20

## ELECTRICAL SPECIFICATION

Operating Temperature :  
-30 C~ +85 C  
Test Freq.: 100KHz/0.5V  
Inductance drop  
≤35% typ. At IDC

SSDE3515	3.70±0.3	3.70±0.3	1.50 max.	1.45	1.00	1.20
SSDE3518	3.70±0.3	3.70±0.3	1.80 max.	1.45	1.00	1.20
SSDE5410	5.60±0.3	5.60±0.3	1.05 max.	1.75	2.50	2.50
SSDE5412	5.60±0.3	5.60±0.3	1.20 max.	1.75	2.50	2.50
SSDE5419	5.60±0.3	5.60±0.3	1.90 max.	1.75	2.50	2.50
SSDE7012	7.20±0.3	7.20±0.3	1.20 max.	2.25	3.50	3.00
SSDE7015	7.20±0.3	7.20±0.3	1.50 max.	2.25	3.50	3.00
SSDE7018	7.20±0.3	7.20±0.3	1.80 max.	2.25	3.50	3.00
SSDE7020	7.20±0.3	7.20±0.3	2.00 max.	2.25	3.50	3.00

L(μH)	RDC (OHM) ±20 %				IDC (A) Max.			
	SSDE2610		SSDE2810H		SSDE2510		SSDE2810H	
1.0	0.092		0.061		1.40		1.15	
1.5			0.074				1.00	
2.2	0.179		0.110		1.00		0.80	
3.3	0.219		0.210		0.85		0.65	
4.7	0.282		0.240		0.70		0.53	
6.8	0.453		0.290		0.61		0.45	
10	0.667		0.480		0.45		0.39	
15	0.857		0.710		0.40		0.32	
22	1.511		1.200		0.33		0.27	
L(μH)	RDC (OHM) ±20 %				IDC (A) Max.			
	SSDE3014	SSDE3512	SSDE3515	SSDE3518	SSDE3014	SSDE3512	SSDE3515	SSDE3518
1.0	0.088			0.029	2.10			2.80
1.5	0.120				2.00			
2.2	0.153	0.095	0.072	0.052	1.60	1.00	1.90	1.95
3.3	0.195	0.141	0.098	0.078	1.40	0.90	1.70	1.53
4.7	0.290	0.198	0.148	0.105	1.20	0.80	1.40	1.40
5.6		0.221				0.78		
6.8	0.356	0.261	0.202	0.156	0.92	0.70	1.20	1.13
8.2	0.495				0.90			
10	0.547	0.378	0.286	0.241	0.80	0.55	0.90	0.90
15	0.696	0.596	0.419	0.335	0.68	0.50	0.70	0.75
22	0.942	0.749	0.622	0.450	0.56	0.40	0.60	0.65
33	1.264		0.980	0.740	0.51		0.50	0.50
47		1.763	1.456	0.941		0.20	0.40	0.38
100	4.042				0.28			
220			6.252	4.435			0.21	0.16
L(μH)	RDC (OHM) ±20 %				IDC (A) Max.			
	SSDE5410	SSDE5412	SSDE5419		SSDE5410	SSDE5412	SSDE5419	
2.2		0.072	0.043			1.40	3.70	
3.3	0.125	0.086	0.057		1.65	1.18	2.90	
4.7	0.163	0.119	0.076		1.31	0.90	2.70	
6.8	0.229	0.166	0.113		1.08	0.73	2.20	
8.2			0.132				1.90	
10	0.337	0.230	0.153		0.86	0.62	1.50	
15	0.489	0.340	0.231		0.72	0.50	1.40	
22	0.734	0.459	0.312		0.65	0.41	1.10	
33	1.055	0.640	0.478		0.54	0.39	0.97	
47	1.056	0.899	0.703		0.43	0.32	0.81	
L(μH)	RDC (OHM) ±20 %				IDC (A) Max.			
	SSDE7012	SSDE7015	SSDE7018	SSDE7020	SSDE7012	SSDE7015	SSDE7018	SSDE7020
2.2		0.042		0.042		2.50		4.60
3.3		0.051		0.058		2.00		4.00
4.7	0.130	0.071	0.058	0.080	1.42	1.80	2.50	3.50
6.8	0.169	0.121	0.084	0.100	1.11	1.40	2.00	2.70
10	0.202	0.163	0.124	0.155	0.95	1.20	1.70	2.00
15	0.343	0.221	0.189	0.212	0.75	0.95	1.30	1.50
22	0.488	0.304	0.272	0.255	0.60	0.75	1.15	1.30
27			0.322				1.05	
33	0.711	0.484	0.385	0.417	0.50	0.62	0.98	1.20
39			0.476				0.87	
47	0.872	0.619		0.577	0.45	0.50		1.00

ATD ELEKTRONIK  
Lužnice 10, 344 01 Domažlice  
T.: 379 723 915 F: 379 725 868  
E-MAIL: info@atd-elektronik.cz  
www.atd-elektronik.cz

